

Ice Machines UK Ltd

Unit 10, LDL Business Centre, Station Road West, Ash Vale, Surrey, GU12 5RT.

Tel: 01252 511611 Fax: 01252 511666

www.icemachines.co.uk e-mail: info@icemachines.co.uk



ICE CUBES MAKERS

Spare Parts Code

xxx981

CP 215V

modello costruttivo **EM2**
model type

da Luglio 2000
from July 2000

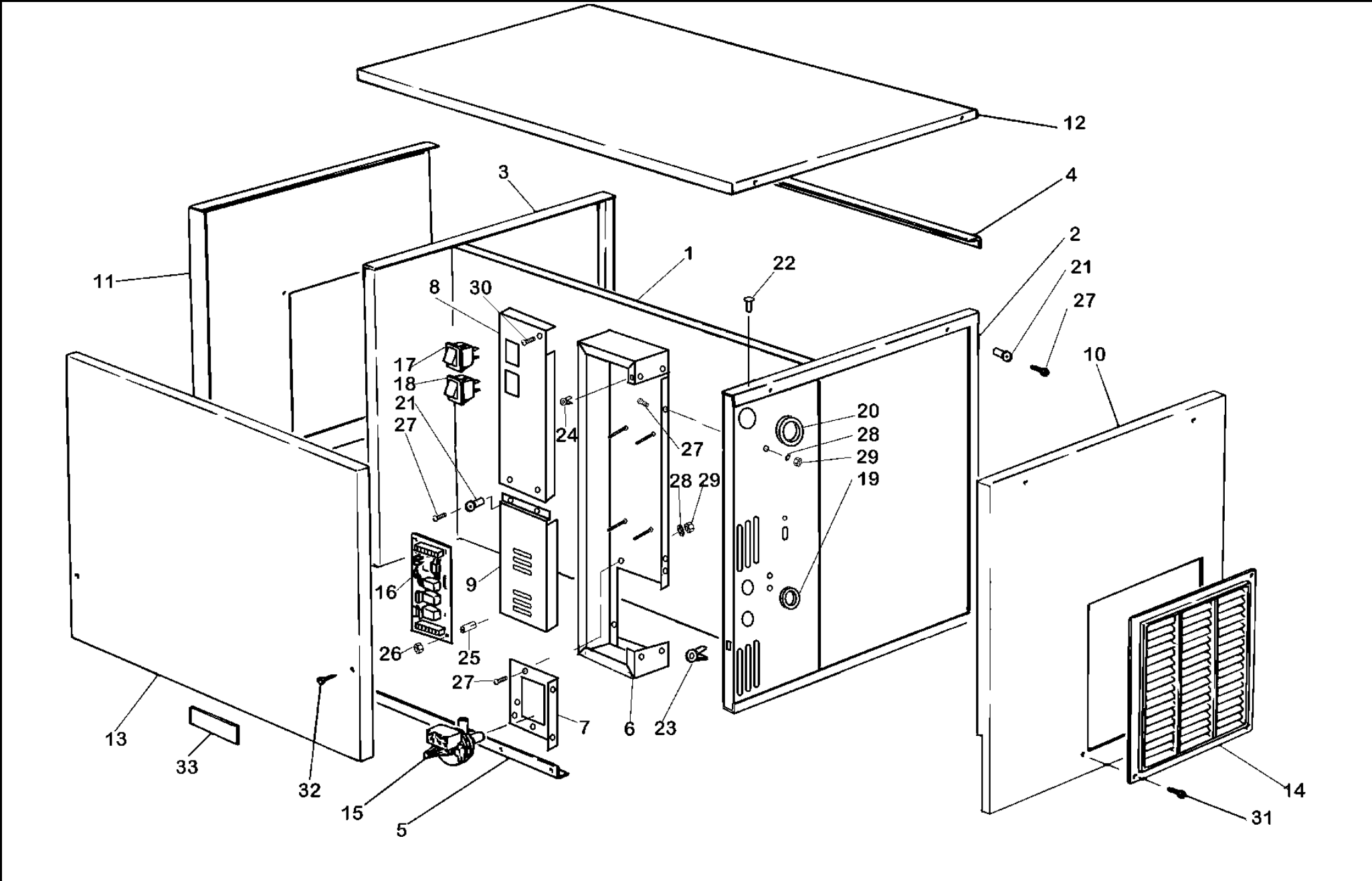

CP 215V E - CP 215V EW – EM2 series

n.		codice	descrizione	description
1		4784B	Parete interna portaevaporatore 215V - EM2	Internal panel - evaporator support 215V – EM2
2		4785	Coppia cornici telaio 215V MII	Left & right frame 215V MII
3				
4		4789	Traversa posteriore telaio 215V MII	Rear cross beam 215V frame MII
5		3535	Traversa anteriore telaio 215 V	Front cross beam 215V frame
6		4786	Scatola porta scheda MII	Electronic board box MII
7		3370	Supporto pompa tipo V	Pump bracket V type
8		4787	Copertura superiore box-scheda MII	Board-box top cover MII
9		3367	Copertura inferiore box-scheda	Board-box bottom cover
10		4793	Fianco destro 215V MII	Right side panel 215V MII
11		4792	Fianco sinistro 215V MII	Left side panel 215V MII
12		4800	Top 215V MII	Top panel 215V MII
13		4227MII	Frontale isolato 215V MII	Insulated front panel 215V MII
14		2043	Aeratore laterale grigio	Lateral gray aerator
15		2380	Pompa elettromagnetica	Water pump
16		6066	Scheda elettronica FAG VM2.1	Electronic board FAG VM2.1
17		1075	Interruttore deviatore I-0-II	Toggle switch I-0-II
18		1050	Interruttore a pulsante	Push botton switch
19		0882	Passafilo piccolo M17	Wire router M17

tavola 1- view 1

n.		codice	descrizione	description
20		3387	Passafilo grande P36	Wire router P36
21		0100	Tuptara M4	4 MA screwed insert
22		1771	Rivetto briv 4x,9	Briv rivet 4x5,9
23		3424	Madrevite plastica grande	Screw grommet large
24		3673	Madrevite plastica piccola	Screw grommet small
25		3425	Distanziale scheda	El.board spacer
26		0219	Dado 3 MA	3 MA nut
27		1509	Vite inox 4 MA x 8	4 MA x 8 TC st.steel screw
28		3645	Rondella dentellata inox d.4	St.Steel tab washer d.4
29		0091	Dado inox M4	St.steel nut d.4
30		0087	Vite inox 3,5x9 TC	St.steel 3,5x9 TC screw
31		0092	Vite 3,5x9 TP	3,5x9 TP screw
32		0089	Vite nichelata 4x32 TGS	4x32 TGS nickel plated screw
33		2117	Targhetta *COMPACT*	*COMPACT* label

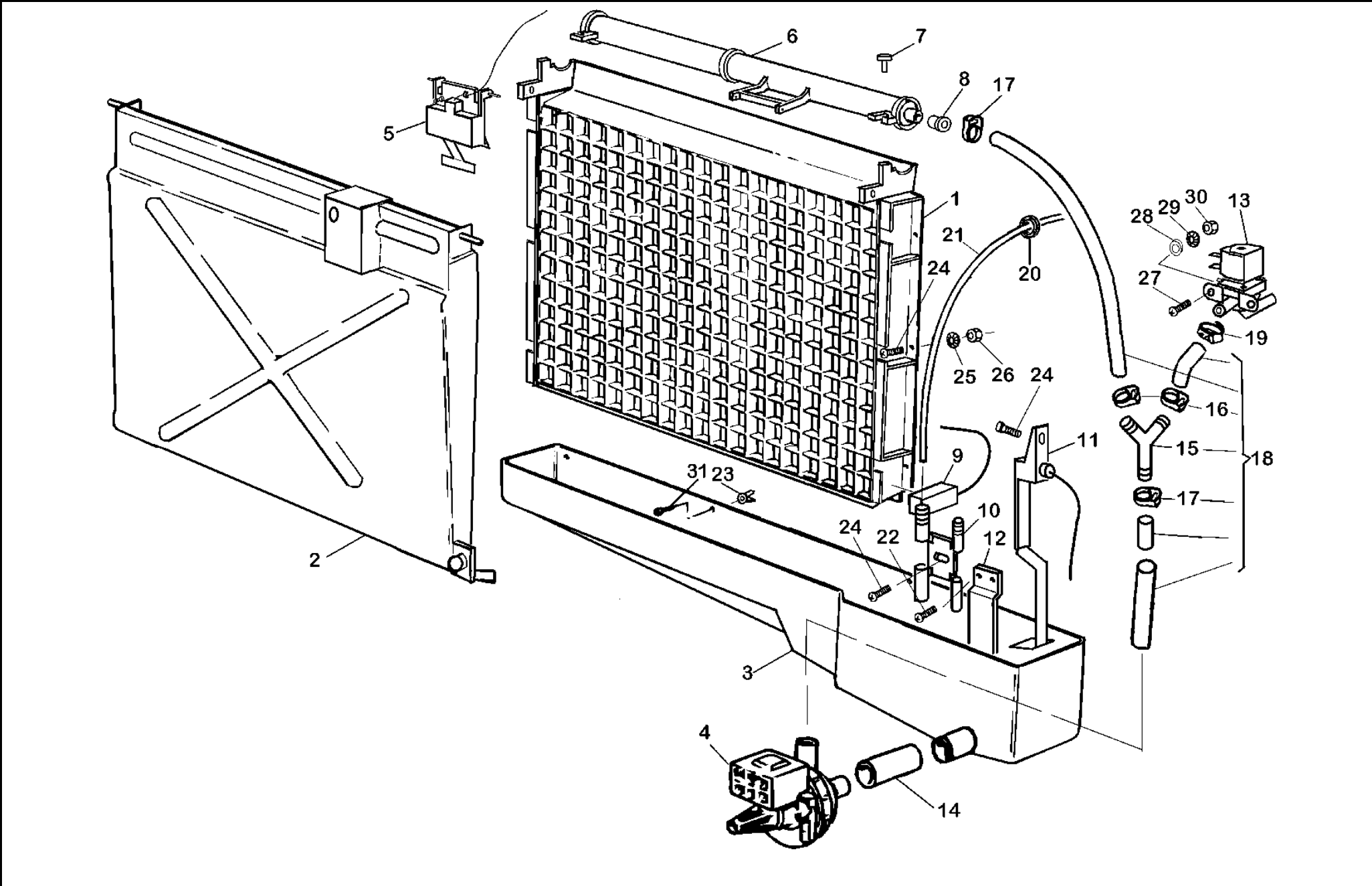

CP 215V E - CP 215V EW – EM2 series

n.		codice	descrizione	description
1	FC	4073	Evaporatore FC 215V cubo grande MII	FC 215V evaporator full cube MII
	MC	4074	Evaporatore MC 215V cubo piccolo MII	MC 215V evaporator mini cube MII
2		4079	Paraspruzzi completo 215V MII	Water curtain complete assy. 215V MII
3		3309	Vaschetta acqua 215V MII	Water sump 215V MII
4		2380	Pompa elettromagnetica	Water pump
5		4077	Sensore spessore ghiaccio	Ice thickness probe
6		4075	Tubo distributore acqua 215V MII	Water distributor set 215V MII
7		4076	Vite fissaggio tubo acqua	Screw for water distributor
8		4801	Riduttore flusso tubo distributore	Water distributor flow reducer
9		4081	Interruttore prossimità magnetico MII	Magnetic proximity switch MII
10		4083	Portagomma MII	Hose holder MII
11		4078	Sensore livello acqua	Water level probe
12		4807	Sensore di terra	Ground probe
13		4768	Valvola scarico 320	Dump Solenoid valve 320
14		4351	Tubo aspirazione pompa MII	Pump-in hose MII
15		0841	Raccordo a Y	Y joint

tavola 2- view 2

n.		codice	descrizione	description
16		0783	Fascetta H	H type clamp
17		2408	Fascetta K	K type clamp
18		4350	Assieme tubi mandata 215V	Pump-out hose assembly 215V
19		4770	Fascetta inox 14x24	14x24 st.steel hose clamp
20		0887	Passafilo P20	Wire router P20
21		0831	Tubo acqua	Water hose
22		1509	Vite inox 4 MA x 8 TC	4 MA x 8 TC st.steel screw
23		3673	Madrevite plastica	Screw grommet
24		6061	Vite 5MA x 16 TC	5MA x 16 TC st. steel screw
25		3674	Rondella dentellata inox d.5	D.5 st.steel tab washer
26		0476	Dado inox d.5	St. steel nut d.5
27		0787	Vite 4MAx12 TC	4MAx12 TC st.steel screw
28		2309	Rondella plastica	Plastics washer
29		3645	Rondella dentellata inox d.4	D.4 st.steel tab washer
30		0091	Dado 4 MA	4 MA nut
31		0087	Vite inox 3,5x9 TC	St.steel 3,5x9 TC screw

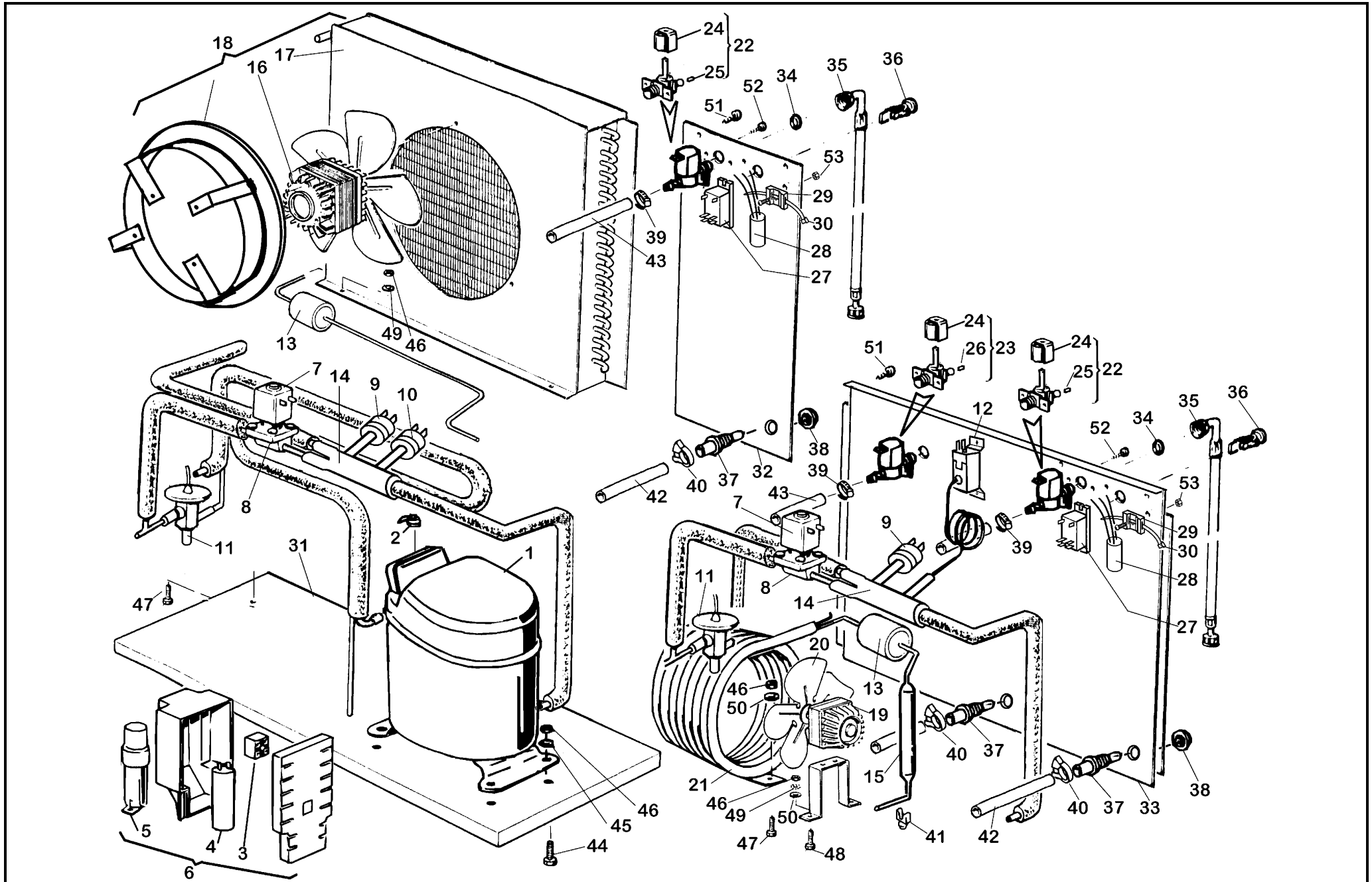

CP 215V E - CP 215V EW – EM2 series

n.		codice	descrizione	description
1		3120	Compressore CAJ4511 Y	CAJ 4511Y compressor
2		4300/3120	Klixon comp. CAJ4511 Y	CAJ4511 Y overlay protector
3		4301/3120	Relais comp. CAJ4511 Y	CAJ4511 Y relay
4		4302/3120	Condensatore avv. CAJ4511Y	CAJ4511 Y starting capacitor
5		4303/3120	Condensat. marcia CAJ4511Y	CAJ4511 Y run capacitor
6		4304/3120	Scatola el. comp. CAJ4511Y	Compressor electric box
7		2658	Bobina valvola gas	Coil for defrost valve
8		3122	Corpo valvola gas d.6	Defrost sol. valve d.6 - body only
9		6072	Pressostato sicurezza R134a	Safety pressure switch R134a
10	A	6071	Pressostato ventilatore R134a	Fan cycling press. switch R134a
11		3123	Valvola espansione R134a a saldare	Expansion valve R134a solder type
12	W	3416	Pressostato condensa HTBX112	Condenser pressure switch HTBX112
13		3121	Filtro 32g	Filter drier 32g
14		4803	Filtro a tre vie d.10	Threw ways filter d.10
15		0516	Ricevitore 30x250	30x250 receiver
16	A	3134	Ventilatore completo 215V	Fan motor complete 215V
17	A	4352	Condensa aria 215V	Air cooled condenser 215V
18	A	3127	Condensa +ventilatore+plenum 215V	Condenser+fan motor+plenum 215V
19	W	0524CE	Ventilatore 10W CE+staffa 38110/B	Fan motor 10 W CE+base 38110/B
20	W	0560	Ventola 200/28	Fan motor blade 200/28
21	W	3496	Condensa ad acqua 9,5 file	Water cooled condenser 9,5 rows
22		4292-12	Valvola acqua singola con riduttori	Single water sol. valve + water flow regulators
23	W	4292-25	Valvola acqua singola con riduttori	Single water sol. valve + water flow regulators
24		0768	Bobina valvola acqua singola	Water valve - coil only
25		0846	Riduttore 1,2	
26	W	0847	Regolatore di flusso 2,5 (arancio)	Water flow regulator 2,5 (orange)

tavola 3- view 3

n.		codice	descrizione	description
27		1074	Relay di potenza	Power relay
28		3428L	Filtro antidisturbi	EM disturbances filter
29		3426	Supporto filtro	Filter support
30		0863	Fascetta cinturino	Wire tie
31		4791	Basamento 215V MII	Base plate 215V MII
32	A	4788	Schienale 215V MII	Rear panel 215V MII
33	W	4806	Schienale 215V W MII	Rear panel 215V W MII
34		0782	Guarnizione tubo carico	Gasket for supply tube
35		0781	Tubo carico acqua	Water supply tube
36		0984	Bloccacavo	Cable entry & terminal block
37		3349	Bocchettone d.20 scarico	Drain d.20 joint
38		2302	Ghiera d.20	D.20 nut
39		4770	Fascetta inox 14x24	14x24 st-steel clamp
40		0783	Fascetta H	Hose clamp H
41		1911	Bloccatubo	Cable clip
42		3433	Tubo scarico	Drain hose
43		0831	Tubo valvola acqua	Water valve tube
44		0533	Vite 6 MA x40 TE	6 MA x 40 TE screw
45		0541	Rondella 6 x 24	6 x 24 washer
46		0534	Dado 6 MA	6 MA nut
47		0536	Vite 6 MA x 10 TE	6 MA x 10 TE screw
48		0540	Vite 6MA x 20 TE	6MA x 20 TE screw
49		0535	Rondella dentellata d.6	Tab washer d.6
50		0537	Rondella 6x18	Washer 6x18
51		0088	Vite 3,5x9 TC	3,5x9 TC screw
52		1509	Vite inox 4MA x8 TC	4MA x 8 TC st.steel screw
53		0091	Dado inox 4MA	St.steel nut d.4

A Solo condensazione ad aria
W Solo condensazione ad acqua

Air cooled models only
Water cooled models only