

# Ice Machines UK Ltd

Unit 10, LDL Business Centre, Station Road West, Ash Vale, Surrey, GU12 5RT.

Tel: 01252 511611 Fax: 01252 511666

[www.icemachines.co.uk](http://www.icemachines.co.uk) e-mail: [info@icemachines.co.uk](mailto:info@icemachines.co.uk)



## CP 315V

---

Spare Parts Code  
xxx991

modello costruttivo **EM2**  
model type

da Luglio 2000  
from July 2000

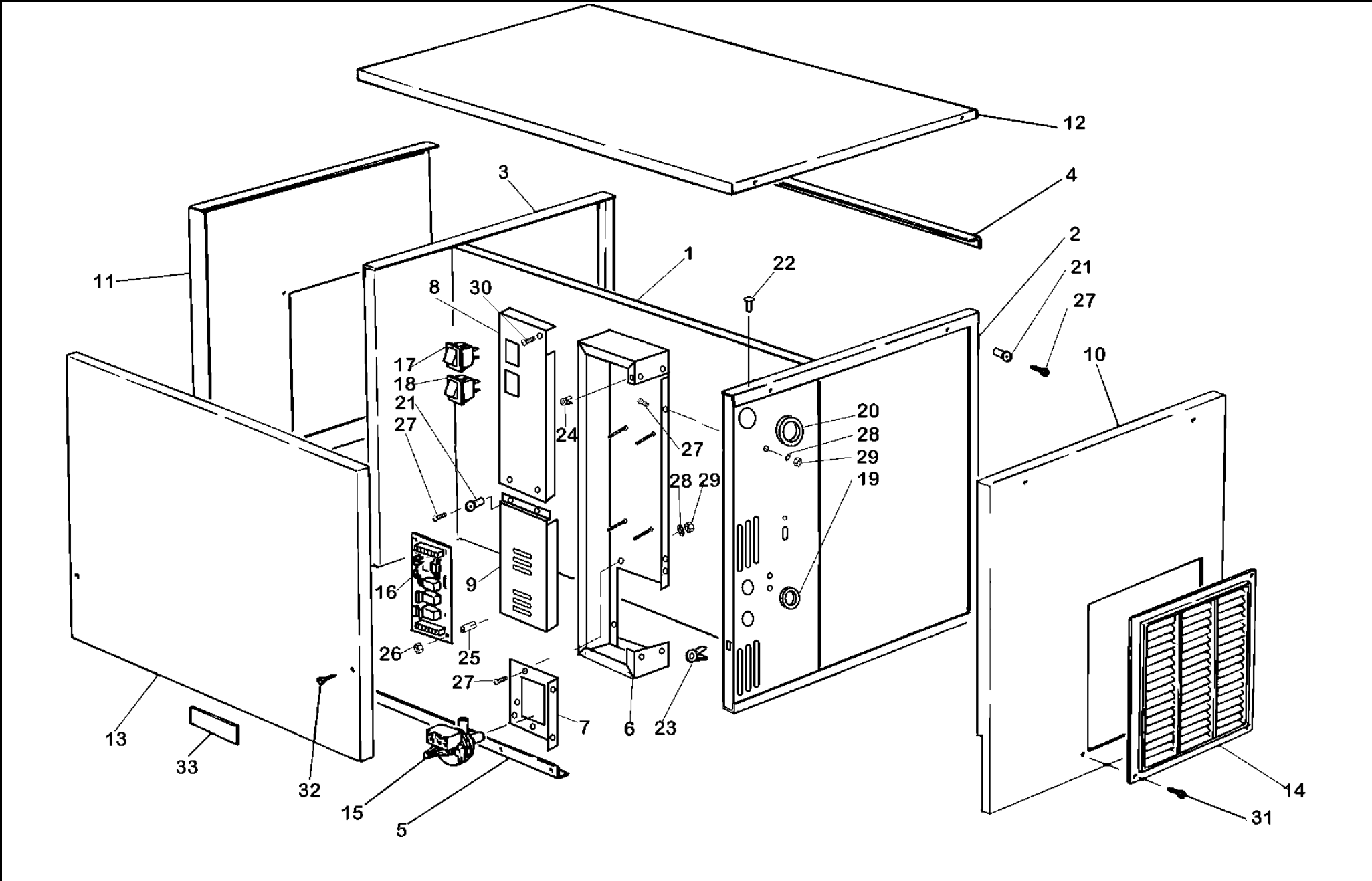

## CP 315V Z – CP 315V ZW – EM2 series

| n. |  | codice  | descrizione                                | description                                    |
|----|--|---------|--|--|
| 1  |  | 4784B   | Parete interna portaevaporatore 215V - EM2 | Internal panel - evaporator support 215V – EM2 |
| 2  |  | 4785    | Coppia cornici telaio 215V MII             | Left & right frame 215V MII                    |
| 3  |  |         |  |  |
| 4  |  | 4789    | Traversa posteriore telaio 215V MII        | Rear cross beam 215V frame MII                 |
| 5  |  | 3535    | Traversa anteriore telaio 215 V            | Front cross beam 215V frame                    |
| 6  |  | 4786    | Scatola porta scheda MII                   | Electronic board box MII                       |
| 7  |  | 3370    | Supporto pompa tipo V                      | Pump bracket V type                            |
| 8  |  | 4787    | Copertura superiore box-scheda MII         | Board-box top cover MII                        |
| 9  |  | 3367    | Copertura inferiore box-scheda             | Board-box bottom cover                         |
| 10 |  | 4793    | Fianco destro 215V MII                     | Right side panel 215V MII                      |
| 11 |  | 4792    | Fianco sinistro 215V MII                   | Left side panel 215V MII                       |
| 12 |  | 4800    | Top 215V MII                               | Top panel 215V MII                             |
| 13 |  | 4227MII | Frontale isolato 215V MII                  | Insulated front panel 215V MII                 |
| 14 |  | 2043    | Aeratore laterale grigio                   | Lateral gray aerator                           |
| 15 |  | 2380    | Pompa elettromagnetica                     | Water pump                                     |
| 16 |  | 6066    | Scheda elettronica FAG VM2.1               | Electronic board FAG VM2.1                     |
| 17 |  | 1075    | Interruttore deviatore I-0-II              | Toggle switch I-0-II                           |
| 18 |  | 1050    | Interruttore a pulsante                    | Push botton switch                             |
| 19 |  | 0882    | Passafilo piccolo M17                      | Wire router M17                                |

## tavola 1- view 1

| n. |  | codice | descrizione                  | description                  |
|----|--|--------|------------------------------|------------------------------|
| 20 |  | 3387   | Passafilo grande P36         | Wire router P36              |
| 21 |  | 0100   | Tuptara M4                   | 4 MA screwed insert          |
| 22 |  | 1771   | Rivetto briv 4x,9            | Briv rivet 4x5,9             |
| 23 |  | 3424   | Madrevite plastica grande    | Screw grommet large          |
| 24 |  | 3673   | Madrevite plastica piccola   | Screw grommet small          |
| 25 |  | 3425   | Distanziale scheda           | El.board spacer              |
| 26 |  | 0219   | Dado 3 MA                    | 3 MA nut                     |
| 27 |  | 1509   | Vite inox 4 MA x 8           | 4 MA x 8 TC st.steel screw   |
| 28 |  | 3645   | Rondella dentellata inox d.4 | St.Steel tab washer d.4      |
| 29 |  | 0091   | Dado inox M4                 | St.steel nut d.4             |
| 30 |  | 0087   | Vite inox 3,5x9 TC           | St.steel 3,5x9 TC screw      |
| 31 |  | 0092   | Vite 3,5x9 TP                | 3,5x9 TP screw               |
| 32 |  | 0089   | Vite nichelata 4x32 TGS      | 4x32 TGS nickel plated screw |
| 33 |  | 2117   | Targhetta *COMPACT*          | * COMPACT * label            |

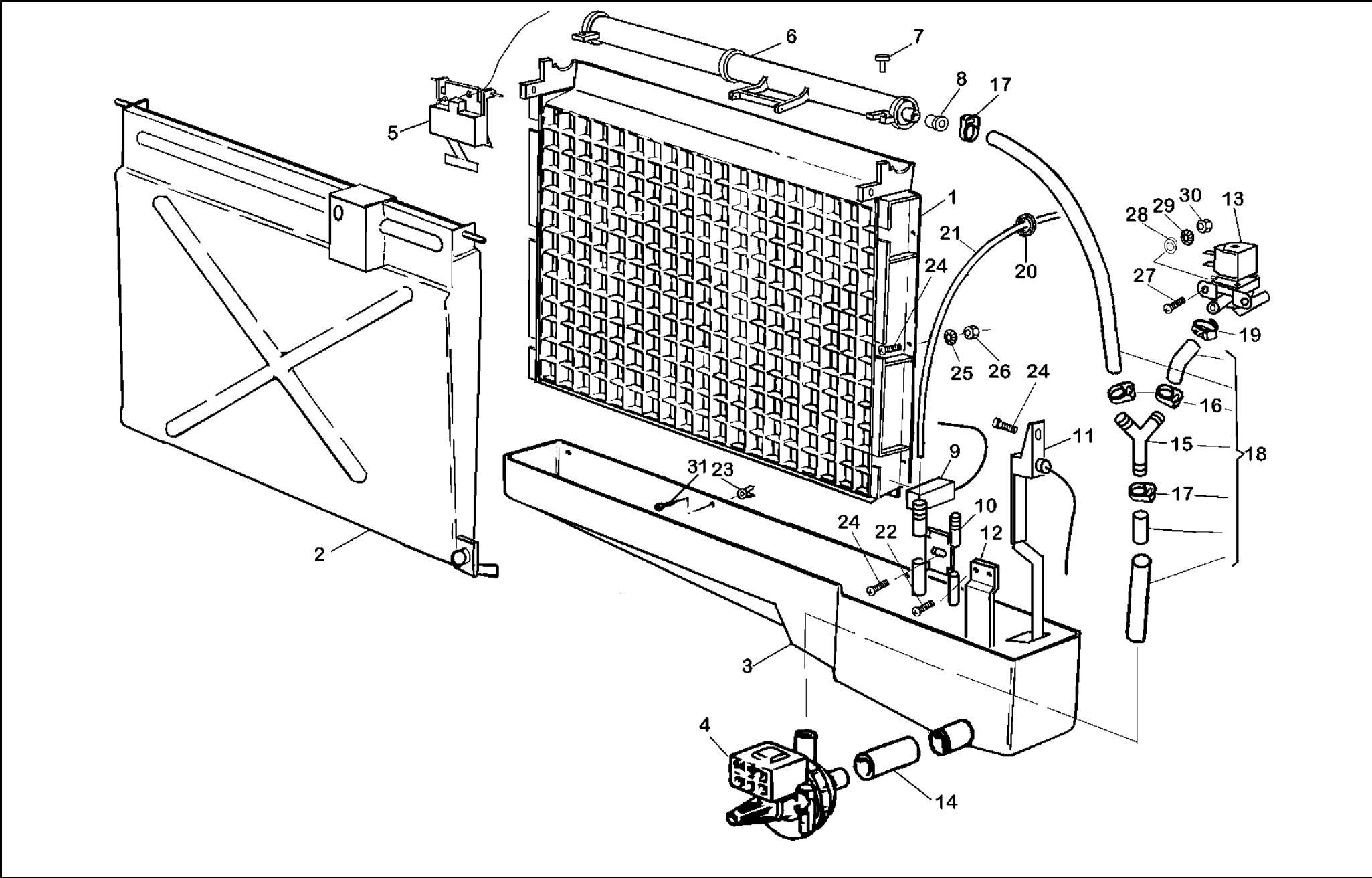

## CP 315V Z – CP 315V ZW – EM2 series

| n. |    | codice | descrizione                           | description                           |
|----|----|--------|---------------------------------------|---------------------------------------|
| 1  | FC | 4073   | Evaporatore FC 215V cubo grande MII   | FC 215V evaporator full cube MII      |
|    | MC | 4074   | Evaporatore MC 215V cubo piccolo MII  | MC 215V evaporator mini cube MII      |
| 2  |    | 4079   | Paraspruzzi completo 215V MII         | Water curtain complete assy. 215V MII |
| 3  |    | 3309   | Vaschetta acqua 215V MII              | Water sump 215V MII                   |
| 4  |    | 2380   | Pompa elettromagnetica                | Water pump                            |
| 5  |    | 4077   | Sensore spessore ghiaccio             | Ice thickness probe                   |
| 6  |    | 4075   | Tubo distributore acqua 215V MII      | Water distributor set 215V MII        |
| 7  |    | 4076   | Vite fissaggio tubo acqua             | Screw for water distributor           |
| 8  |    | 4801   | Riduttore flusso tubo distributore    | Water distributor flow reducer        |
| 9  |    | 4081   | Interruttore prossimità magnetico MII | Magnetic proximity switch MII         |
| 10 |    | 4083   | Portagomma MII                        | Hose holder MII                       |
| 11 |    | 4078   | Sensore livello acqua                 | Water level probe                     |
| 12 |    | 4807   | Sensore di terra                      | Ground probe                          |
| 13 |    | 4768   | Valvola scarico 320                   | Dump Solenoid valve 320               |
| 14 |    | 4351   | Tubo aspirazione pompa MII            | Pump-in hose MII                      |
| 15 |    | 0841   | Raccordo a Y                          | Y joint                               |

## tavola 2- view 2

| n. |  | codice | descrizione                  | description                 |
|----|--|--------|------------------------------|-----------------------------|
| 16 |  | 0783   | Fascetta H                   | H type clamp                |
| 17 |  | 2408   | Fascetta K                   | K type clamp                |
| 18 |  | 4350   | Assieme tubi mandata 215V    | Pump-out hose assembly 215V |
| 19 |  | 4770   | Fascetta inox 14x24          | 14x24 st.steel hose clamp   |
| 20 |  | 0887   | Paasafilo P20                | Wire router P20             |
| 21 |  | 0831   | Tubo acqua                   | Water hose                  |
| 22 |  | 1509   | Vite inox 4 MA x 8 TC        | 4 MA x 8 TC st.steel screw  |
| 23 |  | 3673   | Madrevite plastica           | Screw grommet               |
| 24 |  | 6061   | Vite 5MA x 16 TC             | 5MA x 16 TC st. steel screw |
| 25 |  | 3674   | Rondella dentellata inox d.5 | D.5 st.steel tab washer     |
| 26 |  | 0476   | Dado inox d.5                | St. steel nut d.5           |
| 27 |  | 0787   | Vite 4MAx12 TC               | 4MAx12 TC st.steel screw    |
| 28 |  | 2309   | Rondella plastica            | Plastics washer             |
| 29 |  | 3645   | Rondella dentellata inox d.4 | D.4 st.steel tab washer     |
| 30 |  | 0091   | Dado 4 MA                    | 4 MA nut                    |
| 31 |  | 0087   | Vite inox 3,5x9 TC           | St.steel 3,5x9 TC screw     |

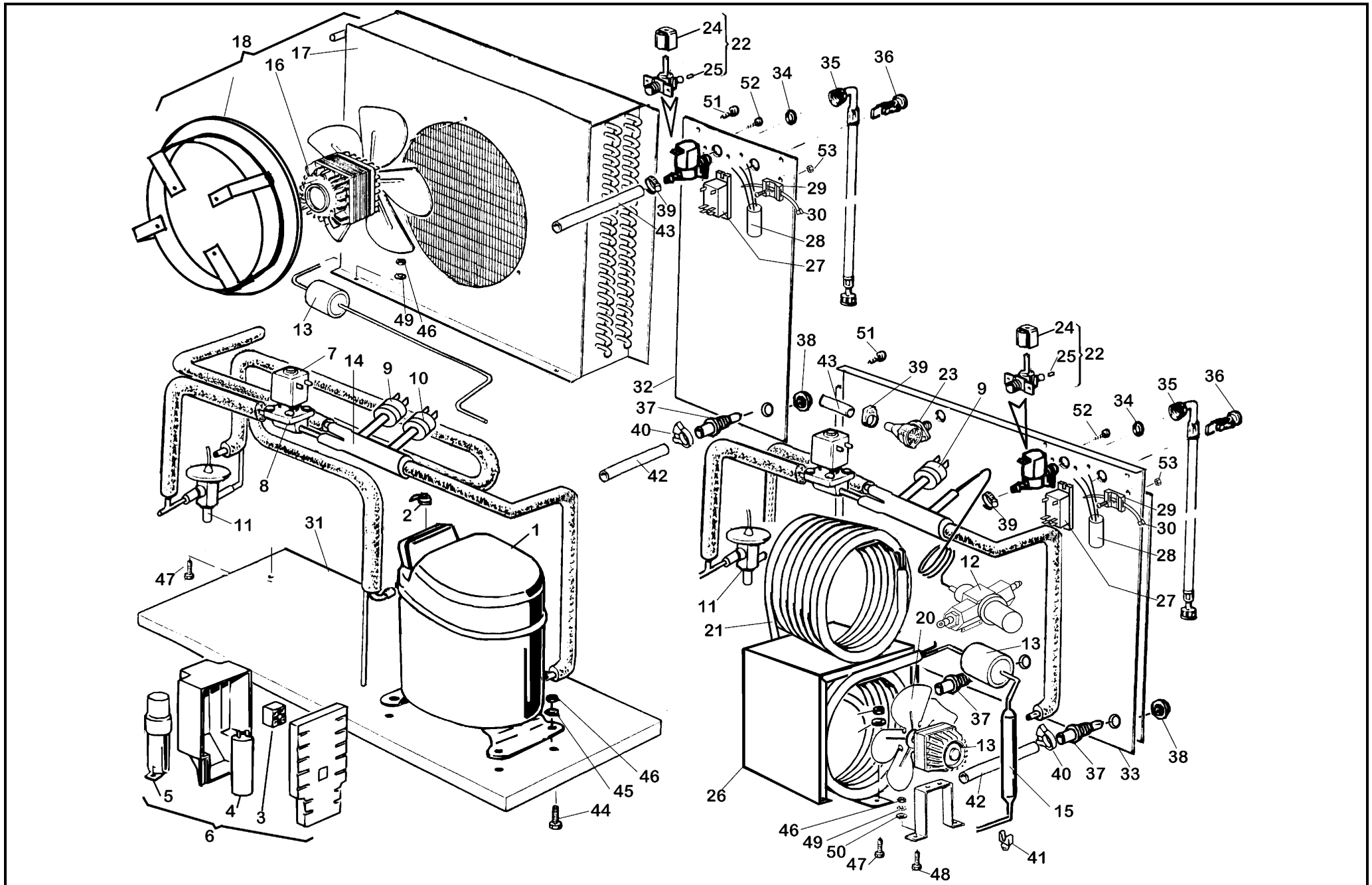

## CP 315V Z – CP 315V ZW – EM2 series

| n. |   | codice    | Descrizione                         | description                                     |
|----|---|-----------|-------------------------------------|---|
| 1  |   | 3354      | Compressore CAJ4519 Z               | CAJ4519 Z compressor                            |
| 2  |   | 4300/3354 | Klixon comp. CAJ4519 Z              | CAJ4519 Z overlay protector                     |
| 3  |   | 4301/3354 | Relais comp. CAJ4519 Z              | CAJ4519 Z relay                                 |
| 4  |   | 4302/3354 | Condensatore avv. CAJ4519 Z         | CAJ4519 Z starting capacitor                    |
| 5  |   | 4303/3354 | Condensat. marcia CAJ4519 Z         | CAJ4519 Z run capacitor                         |
| 6  |   | 4304/3354 | Scatola el. comp. CAJ4519 Z         | Compressor electric box                         |
| 7  |   | 2658      | Bobina valvola gas                  | Coil for defrost valve                          |
| 8  |   | 3122      | Corpo valvola gas d.6               | Defrost sol. valve d.6 - body only              |
| 9  |   | 6074      | Pressostato sicurezza R404a         | Safety pressure switch R404a                    |
| 10 | A | 6073      | Pressostato ventilatore R404a       | Fan cycling press. switch R404a                 |
| 11 |   | 3355      | Valvola espansione R404a a saldare  | Expansion valve R404a solder type               |
| 12 | W | 4329      | Valvola pressostatica II            | Pressostatic valve II                           |
| 13 |   | 3121      | Filtro 32g                          | Filter drier 32g                                |
| 14 |   | 4803      | Filtro a tre vie d.10               | Threw ways filter d.10                          |
| 15 |   | 0516      | Ricevitore 30x250                   | 30x250 receiver                                 |
| 16 | A | 3371FAN   | Ventilatore completo 315V           | Fan motor complete 315V                         |
| 17 | A | 4353      | Condensa aria 315V                  | Air cooled condenser 315V                       |
| 18 | A | 3371      | Condensa +ventilatore+plenum 315V   | Condenser+fan motor+plenum 315V                 |
| 19 | W | 0524CE    | Ventilatore 10W CE+staffa 38110/B   | Fan motor 10 W CE+base 38110/B                  |
| 20 | W | 0560      | Ventola 200/28                      | Fan motor blade 200/28                          |
| 21 | W | 6099      | Condensa ad acqua 315V              | Water cooled condenser 315V                     |
| 22 |   | 4292-12   | Valvola acqua singola con riduttori | Single water sol. valve + water flow regulators |
| 23 | W | 2481      | Valvola RPE singola                 | RPE single water valve                          |
| 24 |   | 0768      | Bobina valvola acqua singola        | Water valve - coil only                         |
| 25 |   | 0846      | Riduttore 1,2                       |   |
| 26 | W | 3606      | Supporto condensa 315/150           | Condenser stand 315/150                         |
| 27 |   | 1074      | Relay di potenza                    | Power relay                                     |

## tavola 3- view 3

| n. |   | codice | descrizione              | description                  |
|----|---|--------|--------------------------|------------------------------|
| 28 |   | 3428L  | Filtro antisturbi        | EM disturbances filter       |
| 29 |   | 3426   | Supporto filtro          | Filter support               |
| 30 |   | 0863   | Fascetta cinturino       | Wire tie                     |
| 31 |   | 4791   | Basamento 215V MII       | Base plate 215V MII          |
| 32 | A | 4788   | Schienale 215V MII       | Rear panel 215V MII          |
| 33 | W | 4806   | Schienale 215V W MII     | Rear panel 215V W MII        |
| 34 |   | 0782   | Guarnizione tubo carico  | Gasket for supply tube       |
| 35 |   | 0781   | Tubo carico acqua        | Water supply tube            |
| 36 |   | 0984   | Bloccacavo               | Cable entry & terminal block |
| 37 |   | 3349   | Bocchettone d.20 scarico | Drain d.20 joint             |
| 38 |   | 2302   | Ghiera d.20              | D.20 nut                     |
| 39 |   | 4770   | Fascetta inox 14x24      | 14x24 st-steel clamp         |
| 40 |   | 0783   | Fascetta H               | Hose clamp H                 |
| 41 |   | 1911   | Bloccatubo               | Cable clip                   |
| 42 |   | 3433   | Tubo scarico             | Drain hose                   |
| 43 |   | 0831   | Tubo valvola acqua       | Water valve tube             |
| 44 |   | 0533   | Vite 6 MA x40 TE         | 6 MA x 40 TE screw           |
| 45 |   | 0541   | Rondella 6 x 24          | 6 x 24 washer                |
| 46 |   | 0534   | Dado 6 MA                | 6 MA nut                     |
| 47 |   | 0536   | Vite 6 MA x 10 TE        | 6 MA x 10 TE screw           |
| 48 |   | 0540   | Vite 6MA x 20 TE         | 6MA x 20 TE screw            |
| 49 |   | 0535   | Rondella dentellata d.6  | Tab washer d.6               |
| 50 |   | 0537   | Rondella 6x18            | Washer 6x18                  |
| 51 |   | 0088   | Vite 3,5x9 TC            | 3,5x9 TC screw               |
| 52 |   | 1509   | Vite inox 4MA x8 TC      | 4MA x 8 TC st.steel screw    |
| 53 |   | 0091   | Dado inox 4MA            | St.steel nut d.4             |

A Solo condensazione ad aria  
W Solo condensazione ad acqua

Air cooled models only  
Water cooled models only